



High Quality

## Modular workshop equipment system

for compilation following individual needs. Freestanding construction, no fixtures and no walls necessary to place, very flexible to install. Each module can be ordered individually. Ball-bearing guided drawers of different heights, fitting all KRAFTWERK-tool inserts (COMPLETO-hardshells, EVA, EVA3) with central locking system and single locking drawers.

With our one-key solution, subsequently it is possible to rebuild all locks with the same lock number so that only one key is needed.

Wide range of accessories compatible to the new pack panels with square holes for professional storage of tools.

As a worktop, different models can be selected depending on the application:

- Beech multiplex/wood
- Stainless steel 430
- Stainless steel 304
- Solid Surface

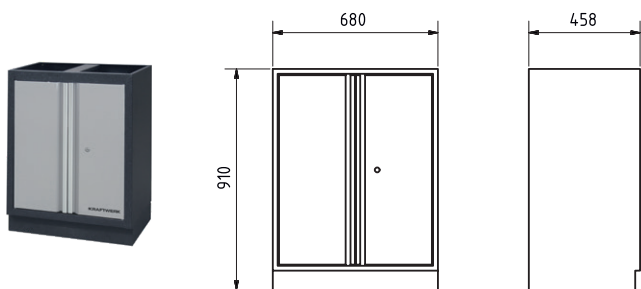

**Art. 3964-03** 2 doors base cabinet, 1 shelf included

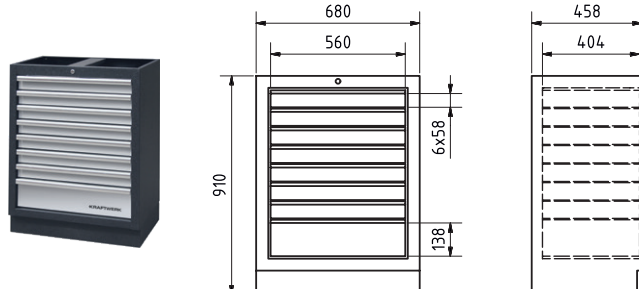

**Art. 3964-14** Base cabinet with 8 drawers

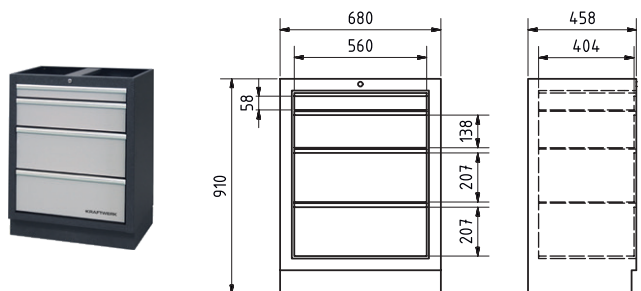

**Art. 3964-04** Base cabinet with 4 drawers

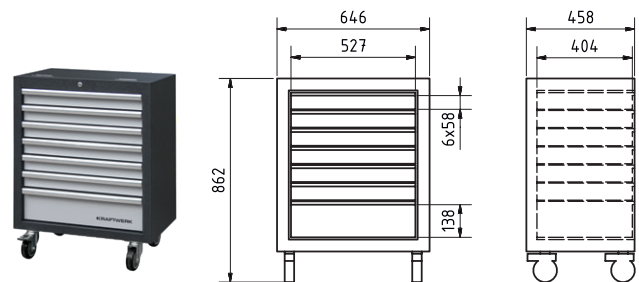

**Art. 3964-15** Rolling base cabinet with 7 drawers

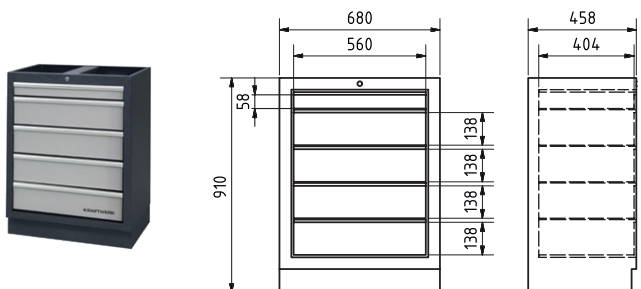

**Art. 3964-05** Base cabinet with 5 drawers

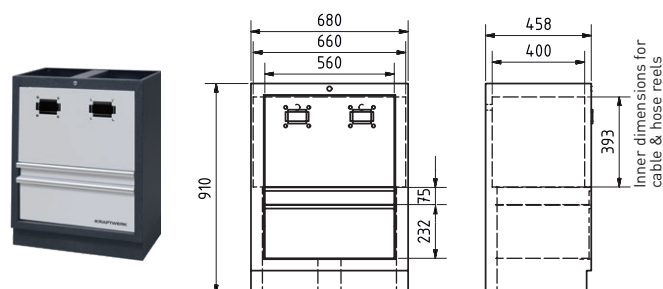

**Art. 3964-28** Base cabinet for cable and hose reels with 2 drawers

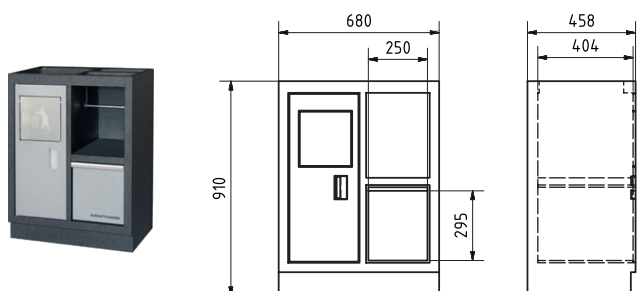

**Art. 3964-11** Base cabinet with waste bin and holder for kitchen rolls

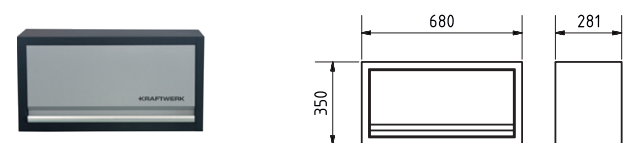

**Art. 3964-01** Wall cabinet with gas spring

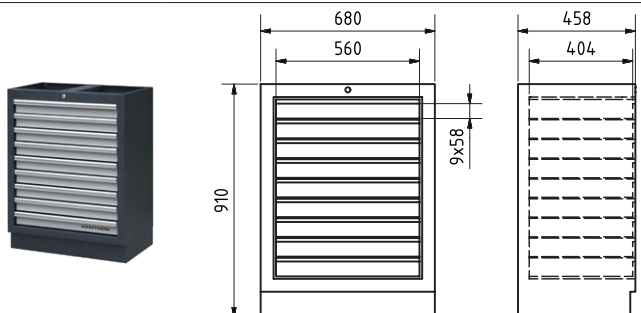

**Art. 3964-13** Base cabinet with 9 drawers

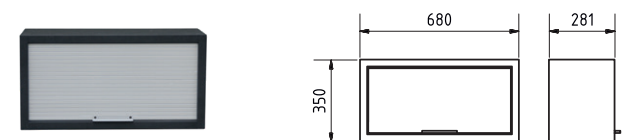

**Art. 3964-19** Wall cabinet with roller shutter



**Art. 3964-03-07** One-Key-Solution (lock 90°) for Art. 3964-02/3964-03/3964-12/3964-16/ 3964-27

**Art. 3964-04-10** One-Key-Solution (lock 180°) for Art. 3964-04/3964-05/3964-13/3964-14/ 3964-15/3964-28

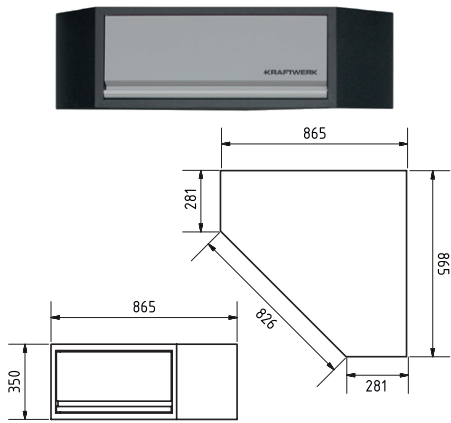

**Art. 3964-25** Corner wall cabinet with gas spring



**Art. 3964-27** 2 door wall cabinet, 1 shelf included

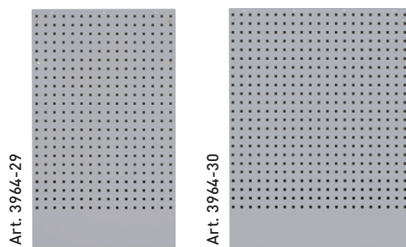

**Art. 3964-29** Hanging panel  
+ 615 x 24 x 1052 mm

**Art. 3964-30** Wall hanging panel for Art. 3964-16  
+ 800 x 24 x 1052 mm

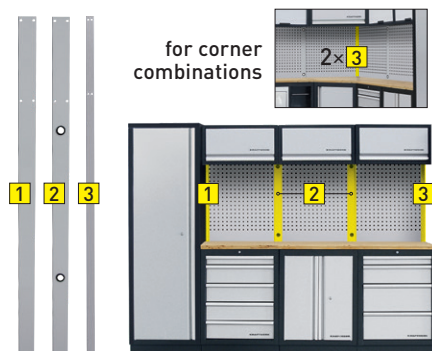

**Art. 3964-24** Connect support for 2 elements  
+ 65 x 30 x 1420 mm

**Art. 3964-07** Connect support with cable holes for 2 elements  
+ 65 x 30 x 1420 mm

**Art. 3964-10** Connect support for outer frame  
+ 32.5 x 30 x 1420 mm

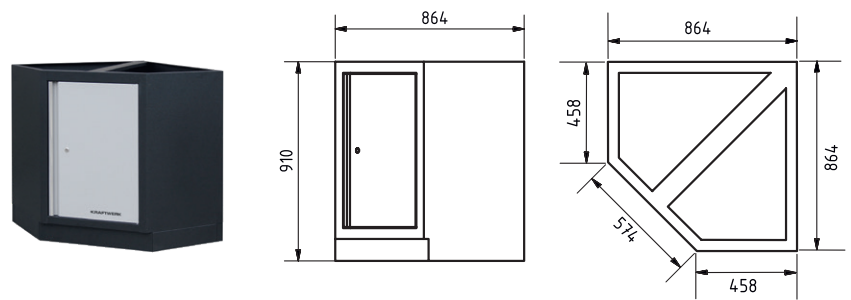

**Art. 3964-16** Corner cabinet with 1 door, 1 shelf included

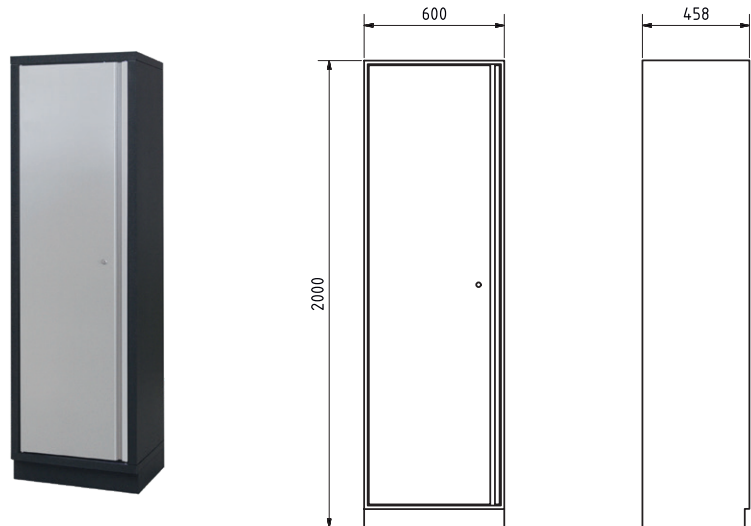

**Art. 3964-02** Locker, 4 shelves included

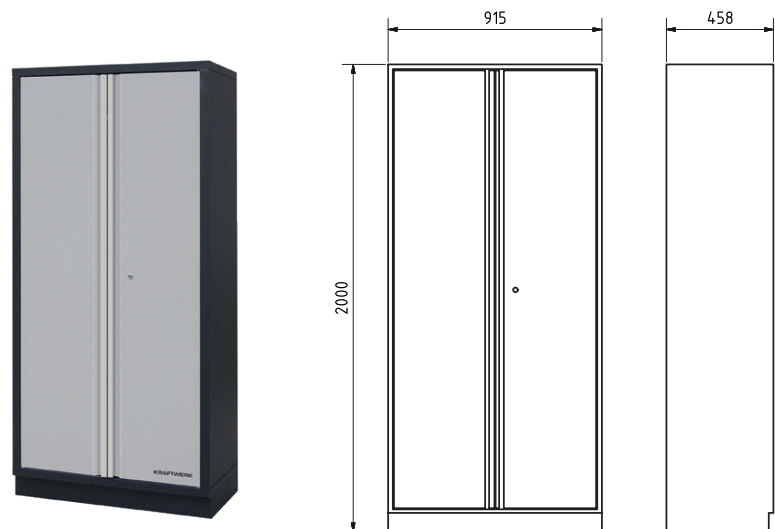

**Art. 3964-12** 2 doors locker, 4 shelves included

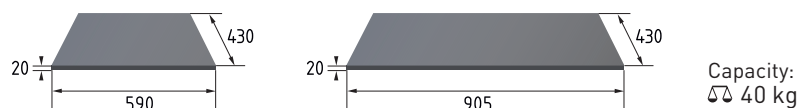

**Art. 3964-02-07** Shelf board for Art. 3964-02

**Art. 3964-12-01** Shelf board for Art. 3964-12





BEECH MULTIPLEX





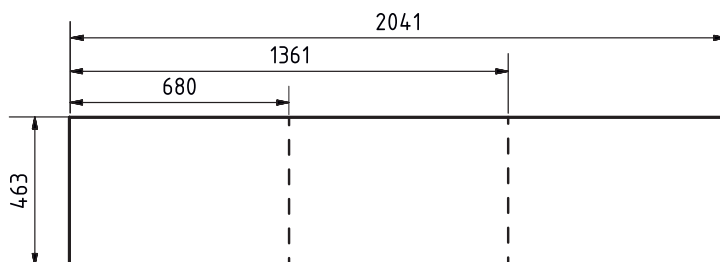

STAINLESS STEEL 304

The **beech multiplex** worktops consist of several layers of peeled veneers, which are connected with an adhesive. These cross-laid veneers ensure the excellent properties of the beech wood, such as high strength and dimensional stability. An appealing and natural look is one of the other advantages of these worktops.

The **stainless steel 304** is commonly known as V2A steel. The stainless steel alloys 304 is characterized by a particularly high nickel and chromium content (18% chromium and 8% nickel), and is therefore highly resilient to heat and cold. Advantages of these alloys are corrosion resistance, the excellent formability, ease of manufacture and cleaning and thanks to its absolutely non-porous surface extremely hygienic. In addition, the stainless steel worktop is resistant to water, steam, humidity, weak organic and inorganic acids and has a wide range of uses.

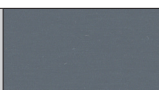
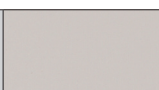

Material		463 x 680 mm for 1 element	463 x 1361 mm for 2 elements	463 x 2041 mm for 3 elements
Beech multiplex		Art. 3964-08	Art. 3964-09	Art. 3964-18
Stainless steel 304 *		Art. 103.009.680	Art. 103.009.361	Art. 103.009.204
Stainless steel 430		Art. 3964-20	Art. 3964-21	Art. 3964-22
Solid Surface   ALPIN WHITE *		Art. 103.010.680	Art. 103.010.361	Art. 103.010.204
Solid Surface   ONYX BLACK *		Art. 103.011.680	Art. 103.011.361	Art. 103.011.204
Solid Surface   CEMENT GREY *		Art. 103.012.680	Art. 103.012.361	Art. 103.012.204
Solid Surface   TOUCH OF GREY *		Art. 103.013.680	Art. 103.013.361	Art. 103.013.204

\* upon request



STAINLESS STEEL 430



SOLID SURFACE

The **stainless steel 430** has a density of 7.70 g/cm<sup>3</sup> and is a ferritic steel. With a chromium content of 17% thus it has good corrosion resistance. Further advantages are a very good polishing ability, deep drawability and bending capacity. The high chromium content gives the steel a good resistance to water, steam, humidity as well as weak acids and alkalis.

**Solid Surface** is a homogenous, non-porous material which consists of a mixture of natural minerals and acrylic resins. It ideally combines practicality with endurance and elegance.

Solid Surface ensures optimum hygiene and antibacterial protections, because no dirt can stick to the surface.

The worktop is protected from UV radiation and maintaining its colour and finish unspoiled for many years.

Solid Surface is highly resistant to stains, as its non-porous synthesis does not allow to colourants to penetrate and deform the material.

The material is durable to frequent use, while at the same time it is easy to clean. Also, if needed, it can be easily repaired, in order to regain its initial beauty.

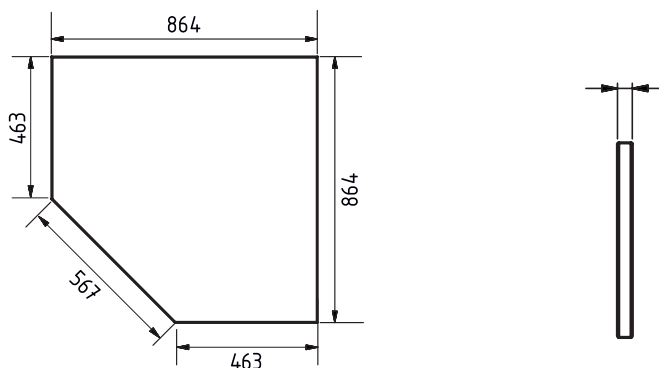

463 x 680 mm for corner case cabinet Art. 3964-16	Thickness mm
Art. 3964-16-99	35
Art. 103.009.001	40
Art. 3964-23	38
Art. 103.010.001	36
Art. 103.011.001	36
Art. 103.012.001	36
Art. 103.013.001	36





Storage tray for cans

Art. 3964-29-01 + 330 x 100 x 100 mm



Bracket for plastic box

Art. 3964-29-11 + 440 x 54 x 15.5 mm



Plastic box blue

Art. 3964-29-14 + 105 x 75 x 140 mm

Art. 3964-29-15 + 140 x 125 x 220 mm

Art. 3964-29-16 + 140 x 125 x 270 mm



Hook with bent tip

Art. 3964-29-02 35 mm

Art. 3964-29-03 87 mm

Art. 3964-29-04 150 mm



Double hook with bent tip

Art. 3964-29-05 35 mm

Art. 3964-29-06 87 mm

Art. 3964-29-07 150 mm

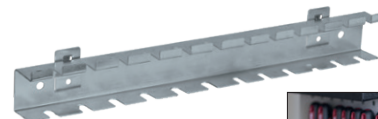

Holder for 12 screwdrivers

Art. 3964-29-10 + 370 x 48 x 33.5 mm

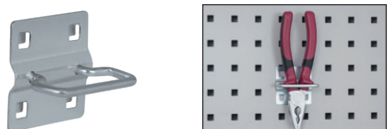

Pliers holder

Art. 3964-29-08 + 60 x 58 x 40.5 mm



Machine holder

Art. 3964-29-09 + 60 x 58 x 58 mm

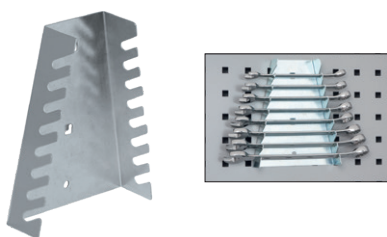
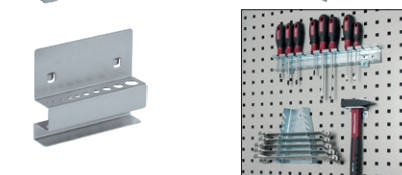
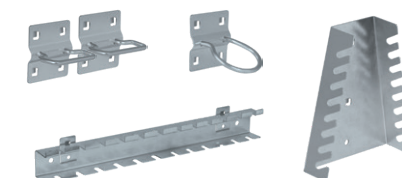
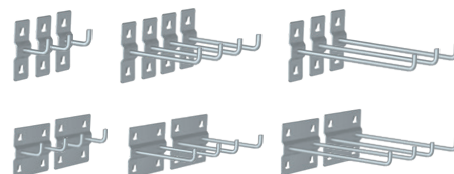

Holder for 8 wrenches

Art. 3964-29-12 + 142 x 176 x 41 mm

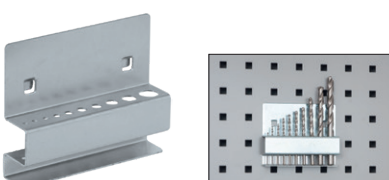

Holder for 10 drills

Art. 3964-29-13 + 112 x 91 x 25 mm

3-2x3.5-4.5-5.5-6.5-7-8.5-10-12.5 mm

Tool holder set, 22-pcs.

Art. 3964-29SET

Insert bins

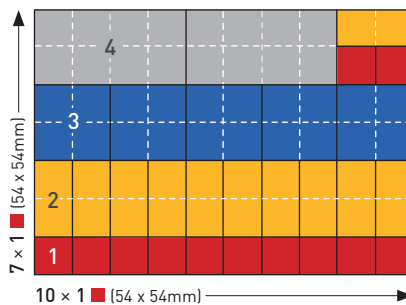



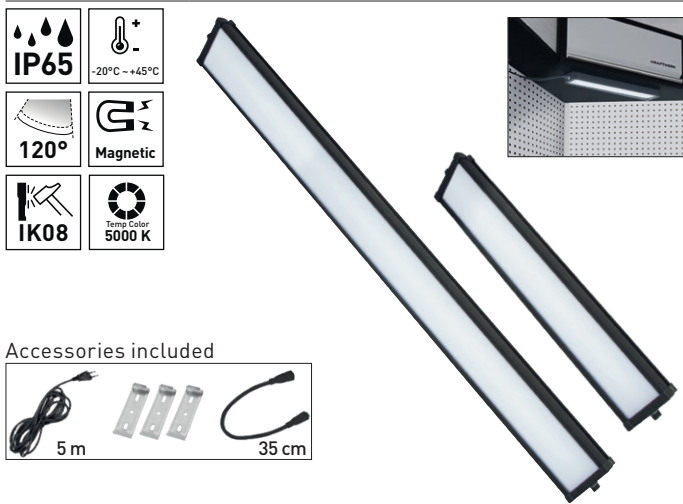

Accessories included



### LED down light

- Flexible use (magnet or U-Brackets)
- Connectable in series
- ON/OFF switch

<b>Art. 32077-60</b>	- 20 W - 120 SMD - 1800 Lumen + 590 x 124 x 43 mm   ⚖ 1.2 kg
<b>Art. 32077-120</b>	- 40 W - 240 SMD - 3600 Lumen + 1200 x 124 x 43 mm   ⚖ 2.3 kg



### Workbenches

- With height-adjustable feet
- 3 cm thick multiplex worktop, splash-proof, dirt-repellent and widely resistant to oil and grease
- Max. load-bearing capacity 150 kg

<b>Art. 7526</b>	+ 1600 x 600 x min. 880   max. 930 mm
<b>Art. 7527</b>	+ 1600 x 800 x min. 880   max. 930 mm



1/4"

-5°C ~ +45°C

max. 18 bar

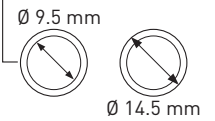

### Automatic air hose reel 15 + 1m

- The housing can be swivelled up to 180°
- With automatic return spring and locking system
- Housing material: PP (Polypropylene)
- Reinforced hose made of hybrid polymer

<b>Art. 31041</b>	Fits for base cabinet Art. 3964-28 + 370 x 180 x 320 mm
-------------------	--

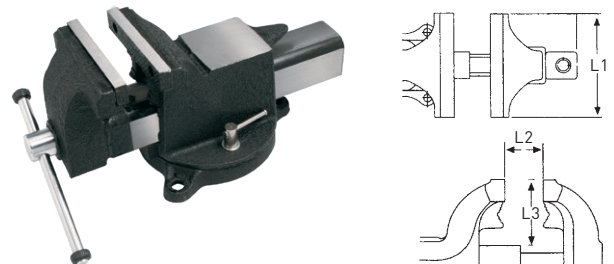

### Parallel steel bench vise

drop forged, with swivel base and tubular clamping jaw, exchangeable hardened clamping jaws, forward opening, with anvil and beak, black enameled. Jaws, guideway and anvil grinded and hardened.

<b>Art. 2961</b>	+ L1 100 x L2 120 x L3 65 mm   ⚖ 7.5 kg
<b>Art. 2962</b>	+ L1 125 x L2 140 x L3 70 mm   ⚖ 11 kg
<b>Art. 2963</b>	+ L1 150 x L2 170 x L3 80 mm   ⚖ 14.5 kg
<b>Art. 2964</b>	+ L1 200 x L2 200 x L3 90 mm   ⚖ 20.5 kg



<b>Art. 3929</b>	Magnetic holder for sockets and pneumatic tools + 400 x 130 x 150 mm
------------------	---

	Insert bin No. 1 red	Insert bin No. 2 yellow	Insert bin No. 3 blue	Insert bin No. 4 grey
Outer dimensions (W x D x H)	54 x 54 x 45/63 mm	54 x 108 x 45/63 mm	108 x 108 x 45/63 mm	108 x 216 x 45/63 mm
Usable dimensions (W x D x H)	48 x 48 x 42/60 mm	48 x 101 x 42/60 mm	101 x 101 x 42/60 mm	101 x 209 x 42/60 mm
Colour				
Art.-No.   Height 45 mm	<b>Art. 198.000.018</b>	<b>Art. 198.000.019</b>	<b>Art. 198.000.020</b>	<b>Art. 198.000.021</b>
Art.-No.   Height 63 mm	<b>Art. 198.000.022</b>	<b>Art. 198.000.023</b>	<b>Art. 198.000.024</b>	<b>Art. 198.000.025</b>

Compatible with all **COMPLETO** inlays

**COMPLETO SERIE 4900**



**COMPLETO EVA SERIE 4902**



**COMPLETO EVA3 SERIE 4903**



You can find the complete range of tool trays in our General Collection catalogue or on our homepage.



Your specialized dealer:

